

Vandal Resistant Switch $\Phi 19\text{mm}$



Anti-Vandal IK09/ Sealed IP65

Normal Open/ Normal Closed

Domed/ Flat/ High Flat

Stainless Steel/ Brass

1,000,000 Cycles Momentary

Order Code

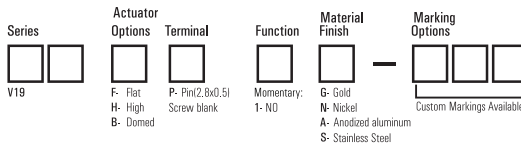

Function

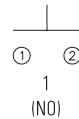

Suggested Panel Cutout

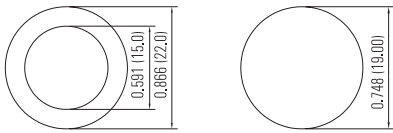

Max. Panel Thickness: 0.394 (10mm)

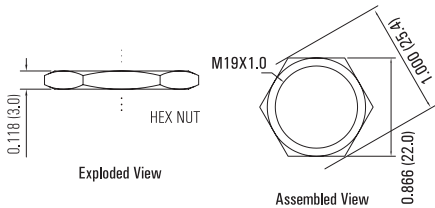

Technical Data

Type	V19-F	V19-B	V19-H
Front Shape	Flat	Domed	High Flat
Terminal	Screw/ Pin (2.8X0.5)		
Max.Switch Rating	2A 48VDC		
Contact Resistance	$\leq 50\text{m}\Omega$		
Insulation Resistance	$\geq 1000\text{m}\Omega$		
Dielectric Strength	2000VAC		
Operation Temp	$-20^\circ\text{C} \sim +55^\circ\text{C}$		
Mechanical Life	1,000,000 Cycles		
Electrical Life	200,000 Cycles		
Contact Material	Silver Alloy		
Torque	5 ~ 14Nm		
Operation Pressure	approx. 5N		
Protection	IP65/ IK09		
Material			
Actuator	Stainless steel/ Gold or Nickel plated brass/ Anodized aluminum		
Body	Stainless steel/ Gold or Nickel plated brass/ Anodized aluminum		
Base	PBT		

Dimension

Screw

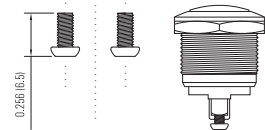
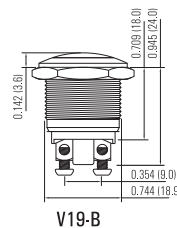
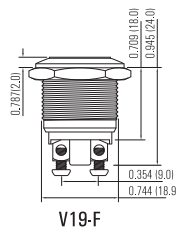
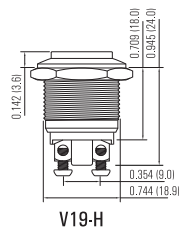

Solder

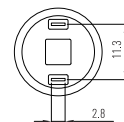
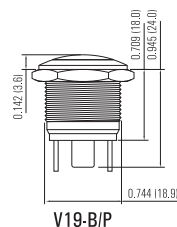
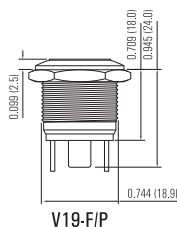
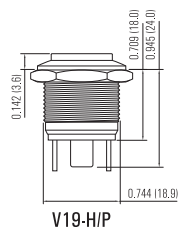

Vandal Resistant Switch $\Phi 19\text{mm}$ (Short)



Anti-Vandal IK09/ Sealed IP65

Normal Open/ Normal Closed

Domed/ Flat/ High Flat

Stainless Steel/ Brass

1,000,000 Cycles Momentary

Order Code

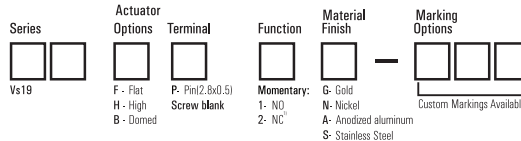

Function

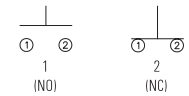

1): Screw terminal available.



Technical Data

Type	Vs19-F	Vs19-B	Vs19-H
Actuator Options	Flat	Domed	High Flat
Terminal	Screw/ Pin (2.8X0.5)		
Max.Switch Rating	2A 48VDC		
Contact Resistance	$\leq 50\text{m}\Omega$		
Insulation Resistance	$\geq 1000\text{m}\Omega$		
Dielectric Strength	2000VAC		
Operation Temp	$-20^\circ\text{C} \sim +55^\circ\text{C}$		
Mechanical Life	1,000,000 Cycles		
Electrical Life	200,000 Cycles		
Contact Material	Silver Alloy		
Torque	5 ~ 14Nm		
Operation Pressure	approx. 5N		
Protection	IP65/ IK09		
Material			
Actuator	Stainless steel/ Gold or Nickel plated brass/ Anodized aluminum		
Body	Stainless steel/ Gold or Nickel plated brass/ Anodized aluminum		
Base	PBT		

Suggested Panel Cutout

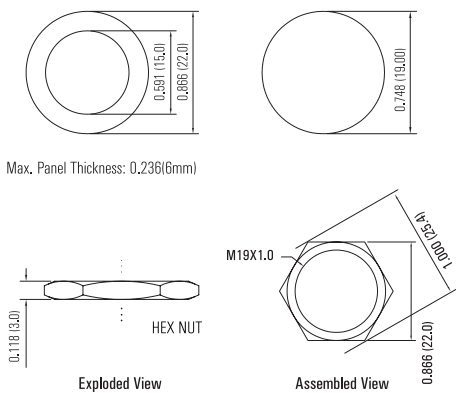

Dimension

Screw

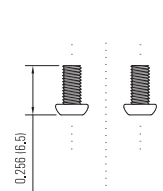
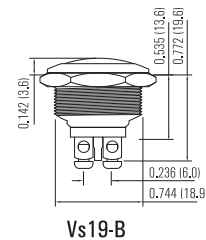
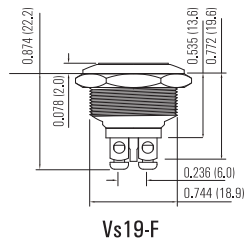
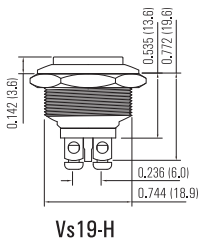

Solder

